

# TEXAS PNEUMATIC TOOLS, INC.

Service, Operation AND Parts Manual

## Rivet Busters



TX-133-6RB  
TX-133-8RB  
TX-133-11RB

TX-133-6RB-OT  
TX-133-8RB-OT  
TX-133-11RB-OT

TOOL SPECIFICATIONS

MODEL #	WEIGHT	LENGTH	CFM CONSUMED	BORE	STROKE	SHANK	BPM	MINIMUM HOSE SIZE
TX-133-6RB TX-133-6RB-OT	28.9 lbs. 13.1 kg	20.75" 52.7 cm	44 CFM 75 m3/hr	1-3/16" 30.2 mm	6" 15.2 cm	Jumbo .866"	1100	1/2" 13 mm
TX-133-8RB TX-133-8RB-OT	30.7 lbs. 13.9 kg	22.75" 57.8 cm	44 CFM 75 m3/hr	1-3/16" 30.2 mm	8" 20.3 cm	Jumbo .866"	960	1/2" 13 mm
TX-133-11RB TX-133-11RB-OT	33.5 lbs. 15.2 kg	25.75" 73.0 cm	50 CFM 85 m3/hr	1-3/16" 30.2 mm	11" 27.9 cm	Jumbo .866"	850	1/2" 13 mm

~ Made in U.S.A. ~

[www.airtools.com](http://www.airtools.com)

Email: [tptinfo@airtools.com](mailto:tptinfo@airtools.com)

TEXAS  
1-800-231-9740  
254-587-2533 (Int'l calls)

NEVADA  
1-800-858-1222

VIRGINIA  
1-800-626-1091

MICHIGAN  
1-877-575-5733

# RIVET BUSTERS

## TX-13301-0T OUTSIDE TRIGGER HANDLE (COMPLETE)

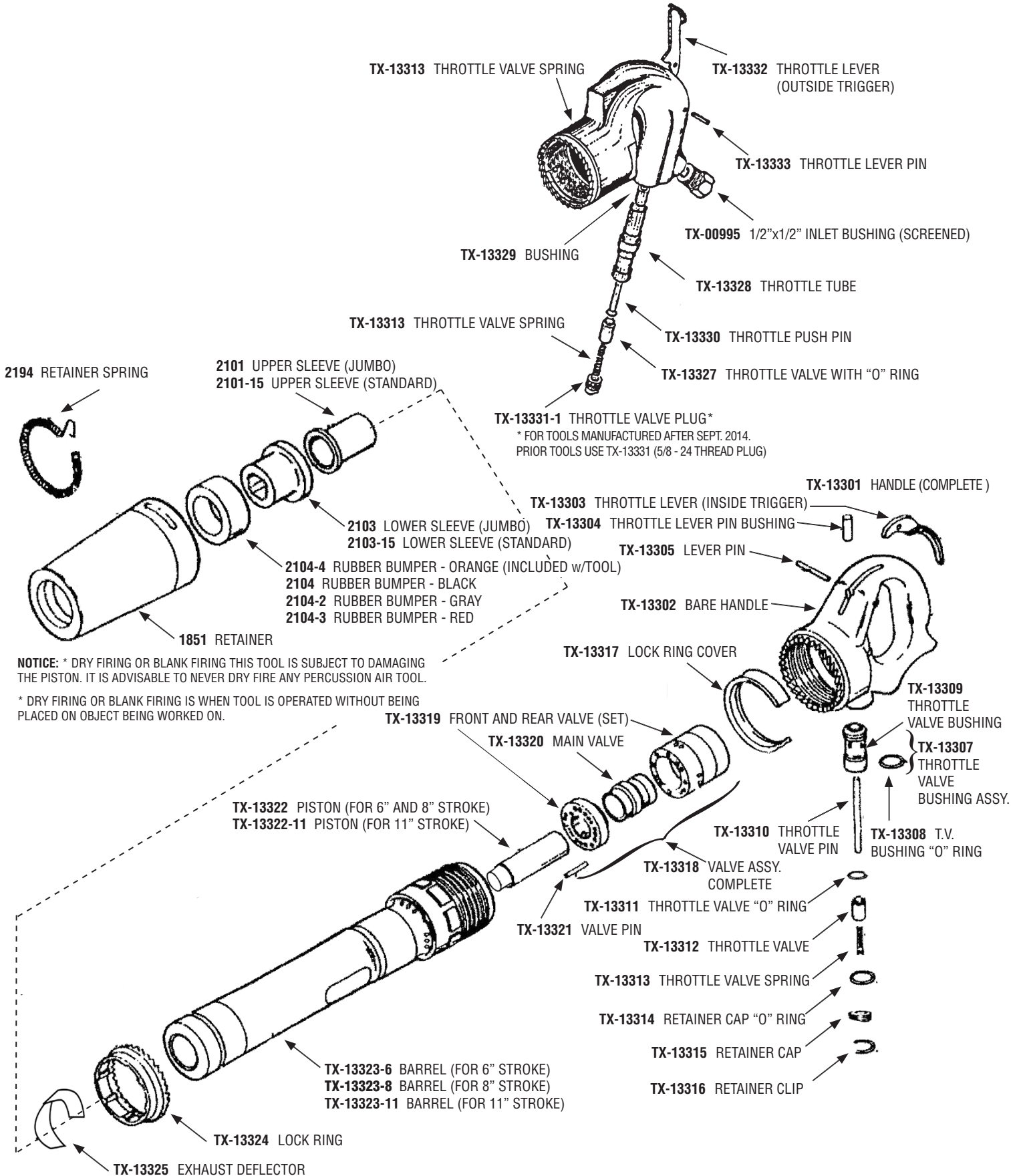

### WARNING

ALWAYS DISCONNECT THE AIR SUPPLY BEFORE ATTEMPTING TO CHANGE A CHISEL, MOIL, OR OTHER ACCESSORY ON A PNEUMATIC TOOL OR BEFORE CARRYING OUT ANY MAINTENANCE OR REPAIR WORK ON THE TOOL.

# Service AND Operations

---

## AIR SUPPLY

For efficient performance, a regulated supply of clean, dry air is required (90 psi at the tool). Most air tools will give superior service if the air is moisture free and lubricated, plus down time will be minimized. If the compressor is pumping excessive water, a cooler or moisture separator (TX-MSS-400 or TX-MSS-800) should be attached to the compressor or air line. A filter, pressure regulator and Texas Pneumatic in-line filter/lubricator (TX-1L-F) should be part of the air line system to the tool. The air supply line should be a minimum 1/2" I.D. hose with no restrictive couplings or fittings in the hose line. If quick disconnect air couplings are used, they should definitely be separated from the tool by the use of a hose whip (TX-8HW-F-1/2) which is included with the purchase of the tool.

## LUBRICATION

An in-line filter/lubricator such as the Texas Pneumatic TX-1L-F is recommended and included with the tool. If an automatic lubricator is not used, it is recommended before using and after 2-3 hours use, to pour several drops of oil into the air inlet port. Texas Pneumatic Lubricating Oil (TX-PL001) or 5 wt. oil of good grade is recommended. A heavy oil will cause loss of power and efficiency. In the matter of preventative maintenance, Texas Pneumatic Tool Flush (TX-TF001) or similar solvent can be used to flush the tool. Add a couple of teaspoons to the air inlet port and operate the tool for a few seconds. It may be necessary to do this several times. The above should be done anytime the tool becomes sluggish or erratic or stops working. Flushing of the tool will most likely remove any foreign particles. After flushing and always before storage (this is most important if the air line has excessive moisture), the tool should be re-lubricated to prevent rust which will cause the tool to malfunction.

## PREPARING FOR OPERATION

Texas Pneumatic Rivet Busters use Arrow Tools Jumbo shank (2000 series) Chisels and Points. Standard shank (1500 series) Chisels and Points can also be used. The Upper and Lower Sleeves for Standard Chisels and Points are 2101-15 and 2103-15. The Upper and Lower Sleeves for Jumbo Chisels and Points are 2101 and 2103. These Jumbo Sleeves are included with the tool when purchased new. The Lower Sleeve uses a Rubber Bumper (2104-4) that comes with the tool. Other Rubber Bumpers (2104 (black), 2104-2 (gray) and 2104-3 (red)) are also available. The durometer (hardness) of these other Bumpers varies. Larger durometers increase the durability of the Bumper.

The Chisels or Points and Sleeves and Bumpers are held in place by the Retainer (1851) and Lock Spring (2194). To replace the Chisels, Points, Sleeves, or Bumpers, it is necessary to remove the Lock Spring from the groove in the tool which will allow the Retainer to be removed from the Barrel. Typically, the Sleeves and Retainer will last longer if the Bumper is changed regularly.

The Barrel (TX-13323-6, TX-13323-8 or TX-13323-11) is made with a safety bridge machined into the metal. The safety bridge keeps the Piston (TX-13322 or TX-13322-11) in the tool even when the Retainer and Sleeves are removed. It is necessary to remove the Handle (TX-13301 or TX-13301-OT) from the Barrel in order to replace the piston.

Once the proper chisel or point has been installed and the tool is ready for use, it is important to follow these safety precautions:

1. Wear eye and ear protection.
  2. Wear safety shoes and proper clothing.
  3. Keep both hands on the tool while operating.
  4. The tool should be kept firmly against the work surface when operating.
  5. Do not allow the tool to bounce against the work surface when operating.
  6. Failure to operate the tool firmly against the work surface (dry fire) will result in damage or breakage to the tool or chisel.
  7. **Never** point a tool at someone during operation.
  8. Disconnect air supply before replacing chisels or points.
-

# Rivet Buster Steel



**Chisel** for cutting loose rivets or breaking concrete.

Length	.766" <b>STANDARD</b>		.866" <b>JUMBO</b>	
	For Steel		For Steel	For Concrete Use
9"	1506		2005	2005C
12"	1506-12		2005-12	2005-12C
18"	1506-18		2005-18	2005-18C
24"	1506-24		2005-24	2005-24C

*\*Must use a split lower sleeve with 24" or longer standard or jumbo chisels*



**Chisel** for busting heads off tight rivets.

9"	1507		2006	
12"	1507-12		2006-12	
18"	1507-18		2006-18	
24"	1507-24		2006-24	

*\*Must use a split lower sleeve with 24" or longer standard or jumbo chisels*



**Ripper Chisel** is used to cut out damaged sections of steel sheets in tank cars, oil storage tanks, and water tanks.

9"	1511		2010	
----	------	--	------	--



**Moil Point** is used for concrete demolition or other hard substances.

9"	1512		2011	2011C
12"	1512-12		2011-12	2011-12C
18"	1512-18		2011-18	2011-18C
24"	1512-24		2011-24	2011-24C

*\*Must use a split lower sleeve with 24" or longer standard or jumbo moil points.*

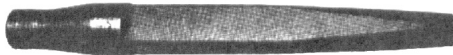

**Backout Punches** are used after rivet heads have been cut to back out tight rivets.

		Rivet Size	Rivet Size	
9"	1508	5/8" Rivet	2007	5/8" Rivet
12"	1508-12		2007-12	
9"	1509	3/4" Rivet	2008	3/4" Rivet
12"	1509-12		2008-12	
9"	1510	7/8" Rivet	2009	7/8" Rivet
12"	1510-12		2009-12	
9"	1515	3/8" Rivet		
12"	1515-12			
9"	1516	1/2" Rivet	2019	1/2" Rivet
12"	1516-12		2019-12	
9"	1517	1" Rivet	2020	1" Rivet
12"	1517		2020-12	
18"			2020-18	
9"			2021	1-1/8" Rivet
12"			2021-12	

**NOTE:**

**\*\*Texas Pneumatic uses a different alloy for chisels and points that will be used for concrete demolition.**